



The Regency Alterra Wood Collection is the next chapter in wood fireplace design, combining the unparalleled tradition of high quality, industry leading engineering with a sleek, modern cast iron finish.

The striking, contemporary design of Alterra CS2400 wood stove puts the focus on the brilliant glowing fire. With an impressive 20% greater viewing area than traditional wood stoves, and a handy fire-wood storage area at its base, the CS2400 is perfectly proportioned for visual pleasure and functional convenience.

Standard Features

- Metallic black cast iron door
- Reversible cast iron door with removable handle
- Ceramic safety glass
- EPA Certified
- Mobile home and alcove approved
- Closest clearances in the industry
- Single rod draft control
- Brick-lined firebox
- Airwash system
- Built-in top louver airmate

Optional Features

- Black or Stainless Steel Side Panels
- Ash drawer
- 2-speed blower
- Outside air kit
- Metallic Black Ember Protection Plate

Specifications	CS2400
Maximum BTU*	75,000
Typical Sq. Ft. Heated	1000-2200
Efficiency	77.0%
Maximum Log Size	18"
Burn Time (Typical)*	up to 8 hrs
Emissions (grams/hr)	3.4g
Firebox Size	2.3 cu. ft.
Flue Size	6"

* Length of burn time and BTU range depend on type of wood, moisture content, climate conditions and installation.

specifications

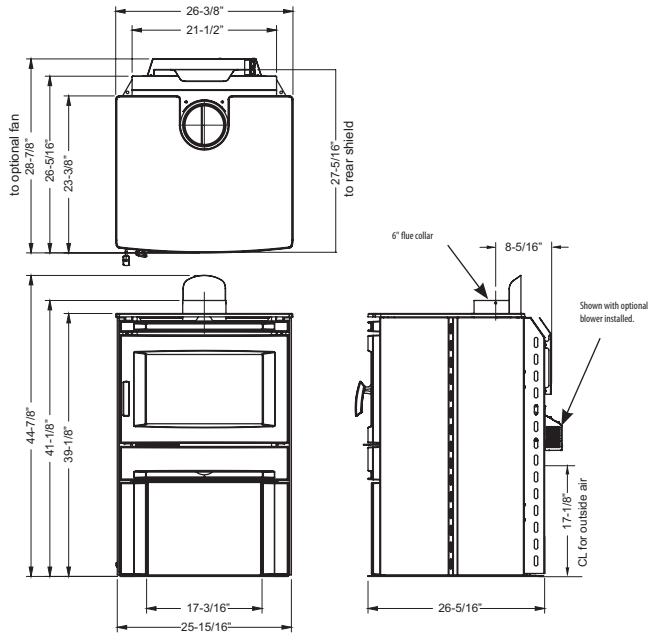

Side panel options



Black



Stainless Steel

Minimum clearance to combustible materials

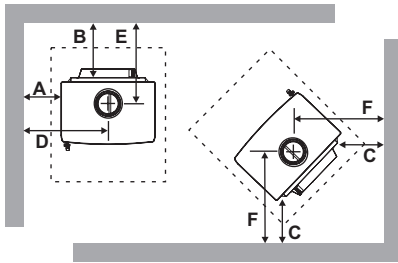

Residential Installation "C" Vent (Single Wall)	FROM UNIT		FROM CORNER		FROM FLUE CENTER-LINE	
	A	B	C	D	E	F
CS2400	18"	12"	6.5"	31"	20-3/8"	19-3/16"
Residential Close Clearance (To be installed with required pipe components)						
CS2400	15"	6.5"	6"	28"	14-7/8"	18-11/16"
Mobile Home Close Clearance (To be installed with required pipe components)						
CS2400	15"	6.5"	6"	28"	14-7/8"	18-11/16"

These clearances are certified clearances for the stove, however, the clearance to the combustibles and the single wall stove pipe must also be maintained. You can reduce the stove pipe clearance with a stove pipe heat shield.

Minimum alcove clearance to combustible materials

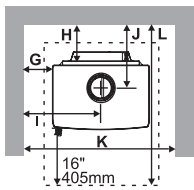

Minimum Alcove Clearance	FROM UNIT		FROM FLUE CENTER-LINE		MIN. WIDTH	Min. Hearth to Rear Wall
	G	H	I	J		
CS2400	15"	6.5"	28"	14-7/8"	56"	47-1/2"

Floor protection

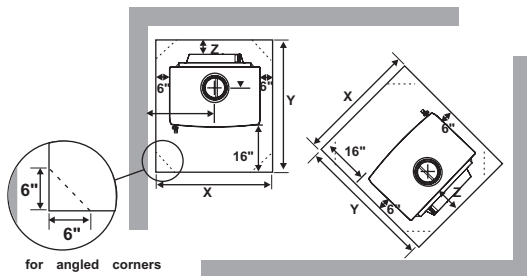

FLOOR PROTECTION	Residential "C" Vent			Residential Close Clearance		Mobile Home Close Clearance		Alcove	
	X*	Y	Z	Y	Z	Y	Z	Y	Z
USA	38-3/8"	47-5/16"	6"	47-5/16"	6"	47-5/16"	6"	47-5/16"	6"
Canada	42-3/8"	51-5/16"	8"	51-5/16"	8"	51-5/16"	8"	51-5/16"	8"

* X - minimum width of floor protector for all installations.

These are guidelines only, subject to change without notice. Always refer to the actual product manual that comes with your unit for specific, current dimensions and clearances.